

**V. Earl Dickinson  
Building  
for Humanities  
and Social Sciences**

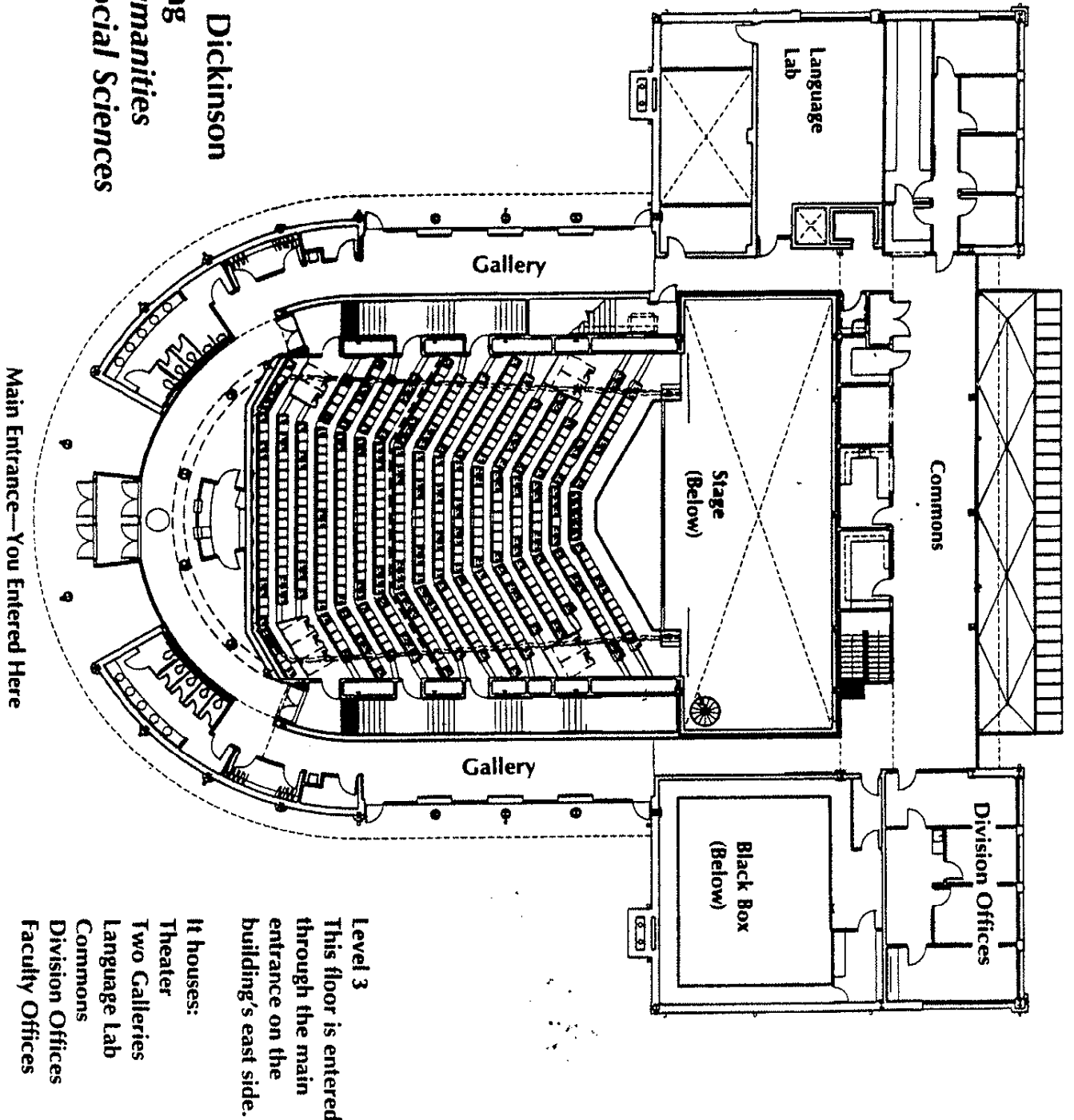

**Level 3**  
This floor is entered through the main entrance on the building's east side.

**It houses:**  
Theater  
Two Galleries  
Language Lab  
Commons  
Division Offices  
Faculty Offices

**Dewberry & Davis**

Architects Engineers Planners Surveyors  
 Three Johns Center  
 1061 East Cary Street, Suite 800  
 Raleigh, Virginia 27618-4029  
 (804) 843-8081 FAX (804) 843-8082

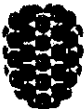

LEVEL 3 PLAN

HUMANITIES AND SOCIAL  
SCIENCE BUILDING

PIEDMONT VIRGINIA  
COMMUNITY COLLEGE  
CHARLOTTEVILLE, VIRGINIA

V. Earl Dickinson Building  
for Humanities and Social Sciences

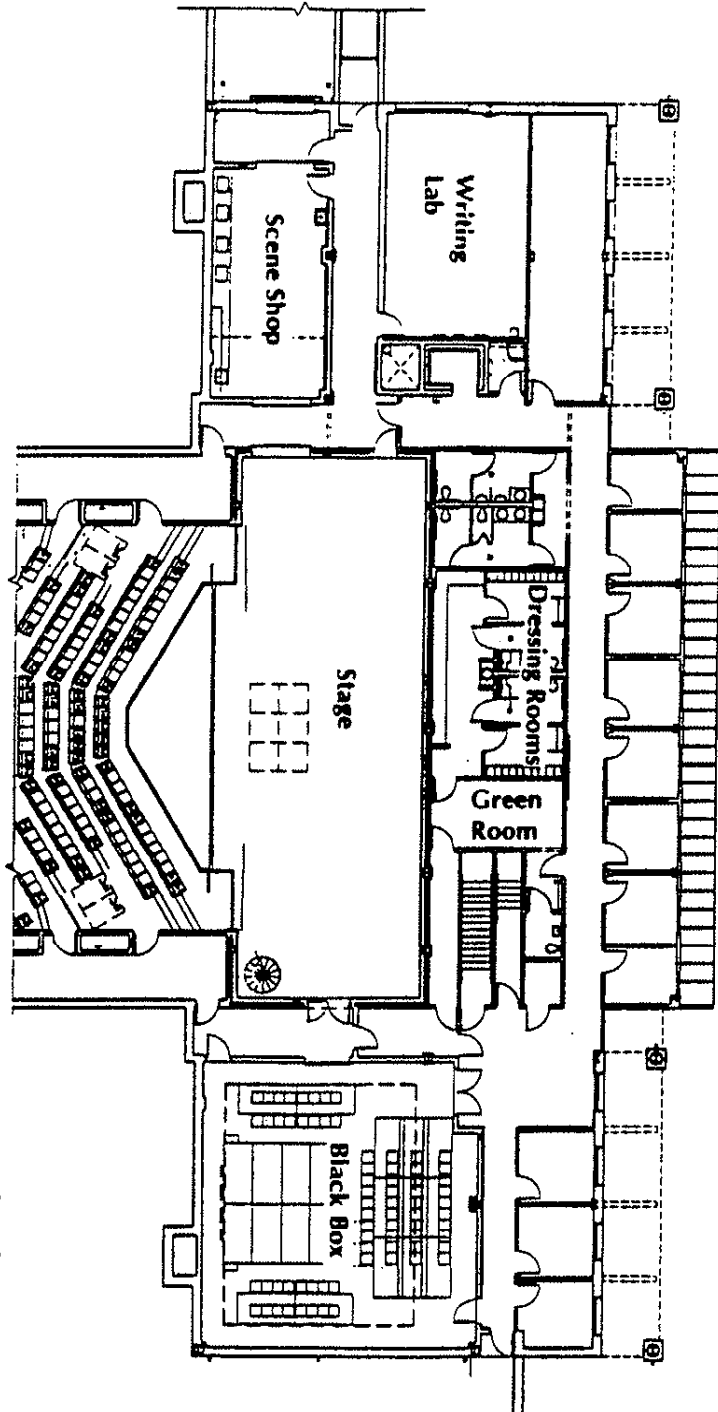

Level 2  
This is ground level  
for the stage.

Level 2 also houses:  
Scene Shop  
Writing Lab  
Green Room  
Black Box  
Faculty Offices

**Dewberry & Davis**

Architects Engineers Planners Surveyors

Three James Center  
1001 East Cary Street, Suite 900  
Richmond, Virginia 23219-4689

(804) 643-6881 FAX / (804) 643-6882



LEVEL 2 PLAN

HUMANITIES AND SOCIAL  
SCIENCES BUILDING

PIEDMONT VIRGINIA  
COMMUNITY COLLEGE

V. Earl Dickinson Building  
for Humanities and Social Sciences

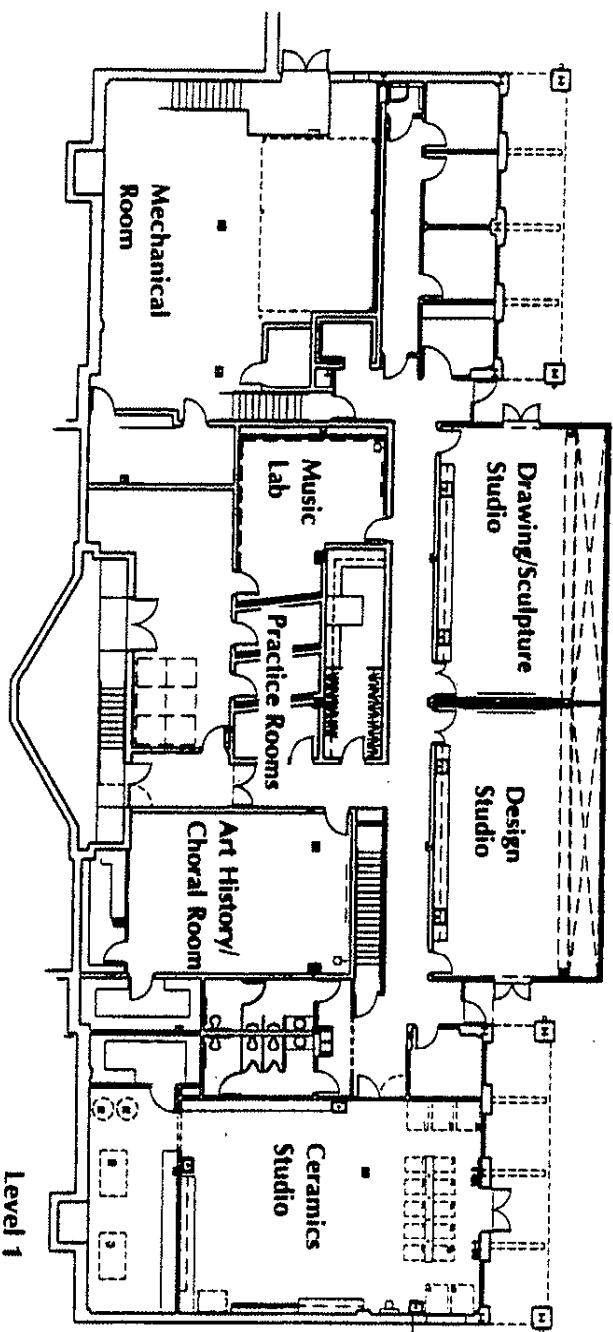

Level 1

Access to the amphitheater is reached from this level.

- It houses:
- Ceramics Studio
  - Design Studio
  - Drawing/Sculpture Studio
  - Music Lab
  - Practice Rooms
  - Art History/Choral Room
  - Mechanical Room
  - Faculty Offices

**Dewberry & Davis**  
Architects Engineers Planners Surveyors  
Three James Center  
1201 East Cary Street, Suite 600  
Richmond, Virginia 23219-4628  
© 1998  
(804) 843-8061 FAX / (804) 843-8063



LEVEL 1 PLAN

HUMANITIES AND SOCIAL  
SCIENCES BUILDING  
—  
PIEDMONT VIRGINIA  
COMMUNITY COLLEGE  
CHARLOTTEVILLE VIRGINIA



# PIEDMONT VIRGINIA COMMUNITY COLLEGE V. EARL DICKINSON BUILDING THEATER

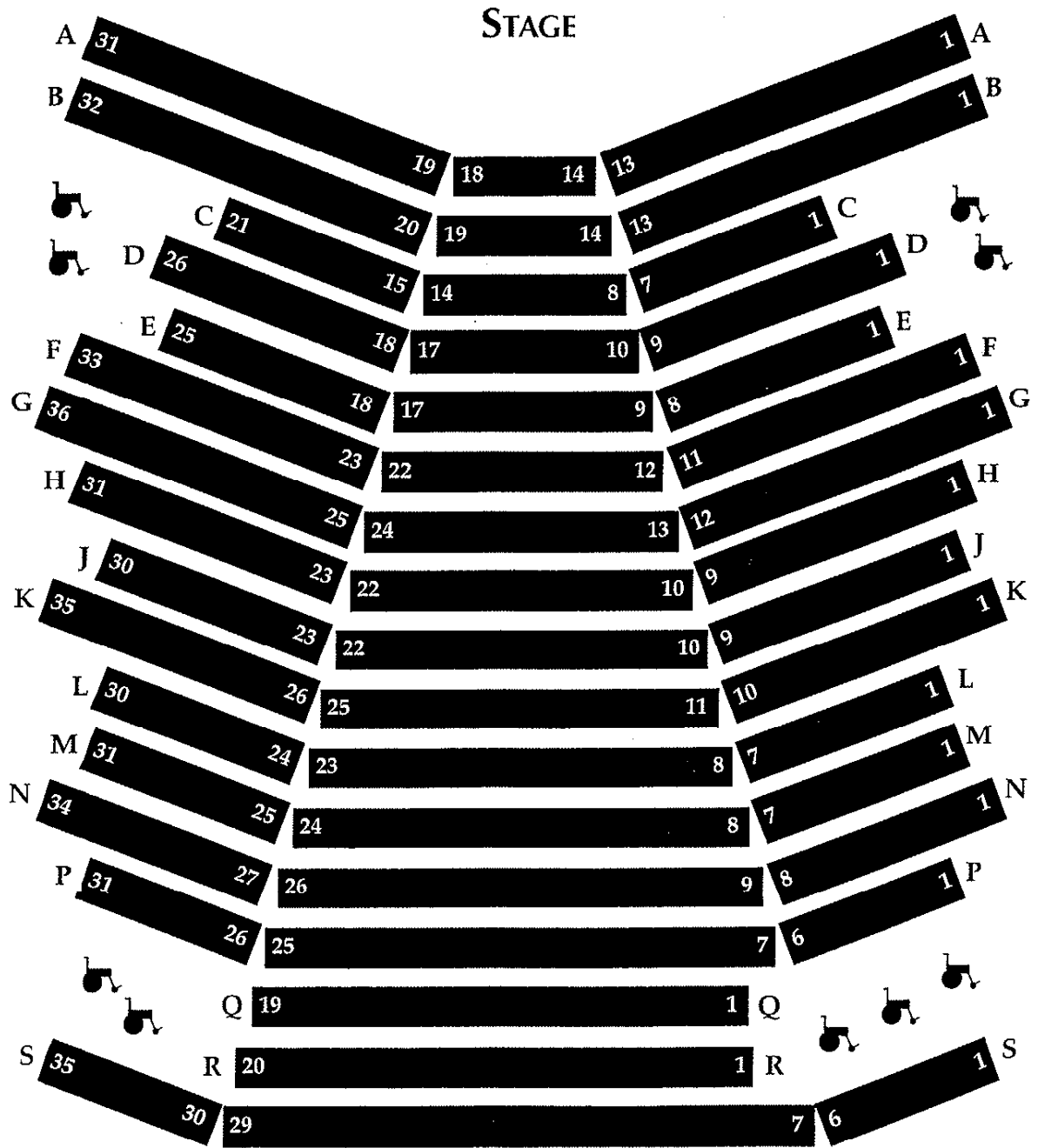

Exit (to hall)

Roll Door to Scene Shop  
Max width = 8'1"  
Height = 10'6 5/8"

Legend:

■ Indicates a stage-pin circuit location

— Indicates a traveler track

Notes:

Grid Bays NOT exact

Movie screen width estimated

SL Double Door width estimated

Disclaimer:

This ground plan is meant to serve as an aid in the design process. Measurements have NOT been verified and should NOT be used to plan critical applications. As always, you should take any measurements critical to your production. Drafter assumes no responsibility for the accuracy of this ground plan.

Centerline

PETERSON WHEEL OPERATING COMPANY	
VE. Dickinson Building Mainstage	
Ground Plan	Page
Drawing Catalogue No. 1000	1
DATE: 10/27/04	BY: [Signature]

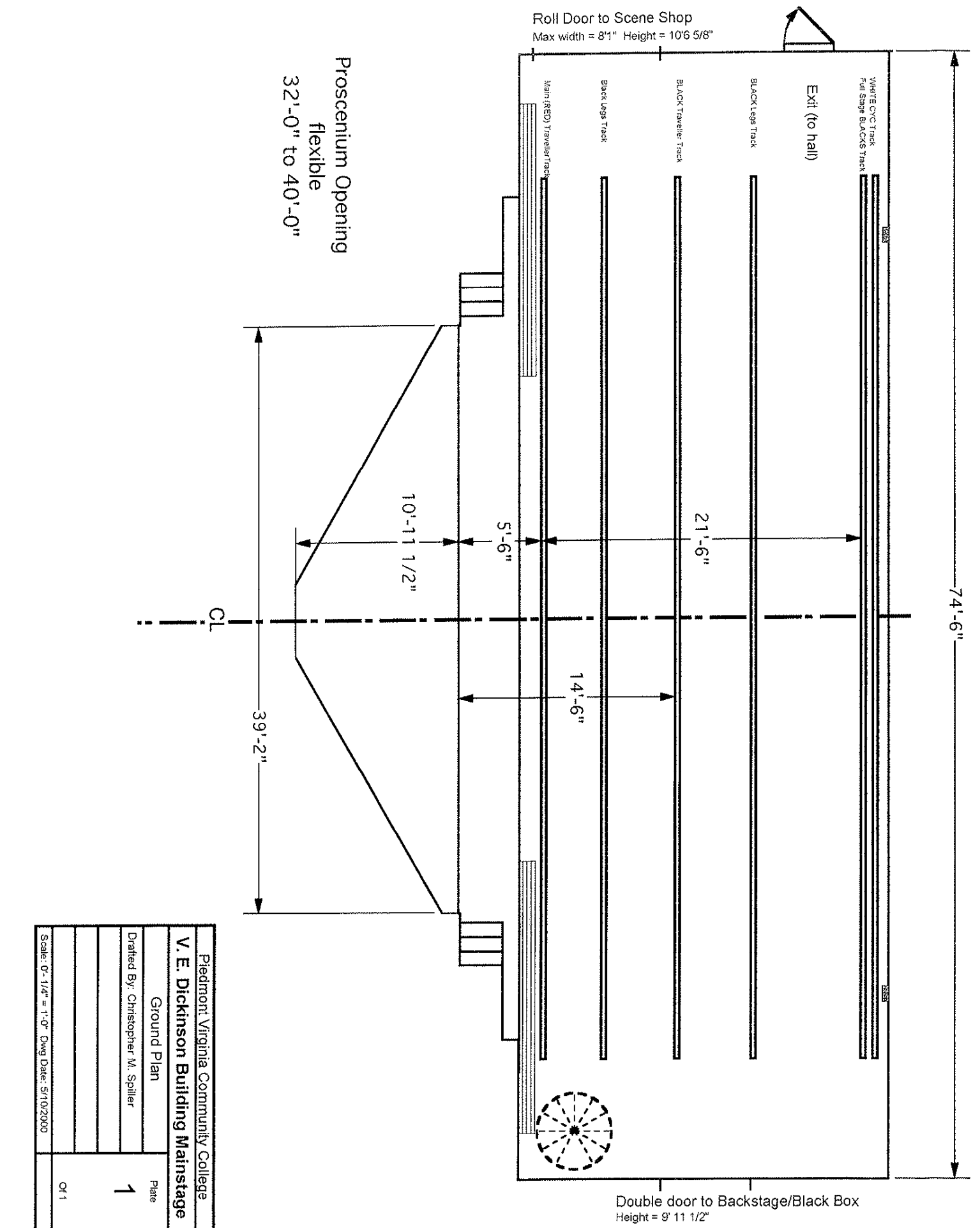

Roll Door to Scene Shop  
 Max width = 8'1" Height = 10'6 5/8"

Proscenium Opening  
 flexible  
 32'-0" to 40'-0"

74'-6"

39'-2"

CL

WHITE O/C Track  
 Full Stage BLACKS Track

Exit (to hall)

BLACK Legs Track

BLACK Traveler Track

Back Legs Track

Main (RED) Traveler Track

21'-6"

14'-6"

5'-6"

10'-11 1/2"

Double door to Backstage/Black Box  
 Height = 9' 11 1/2"

Piedmont Virginia Community College	
<b>V. E. Dickinson Building Mainstage</b>	
Ground Plan	Plate
Drafted By: Christopher M. Spiller	1
Scale: 0'-1/4" = 1'-0" Dwg Date: 5/10/2000	Of 1

Roll Door to Scene Shop  
 Max width = 8'1" Height = 10'6 5/8"

WHITE CYC Track  
 Full Stage BLACKS Track

Exit (to hall)

BLACK Legs Track

BLACK Traveller Track

Stack Legs Track

Main (RED) Traveller Track

Proscenium Opening  
 flexible  
 32'-0" to 40'-0"

Note: Grid Bays NOT exact  
 Movie screen width estimated

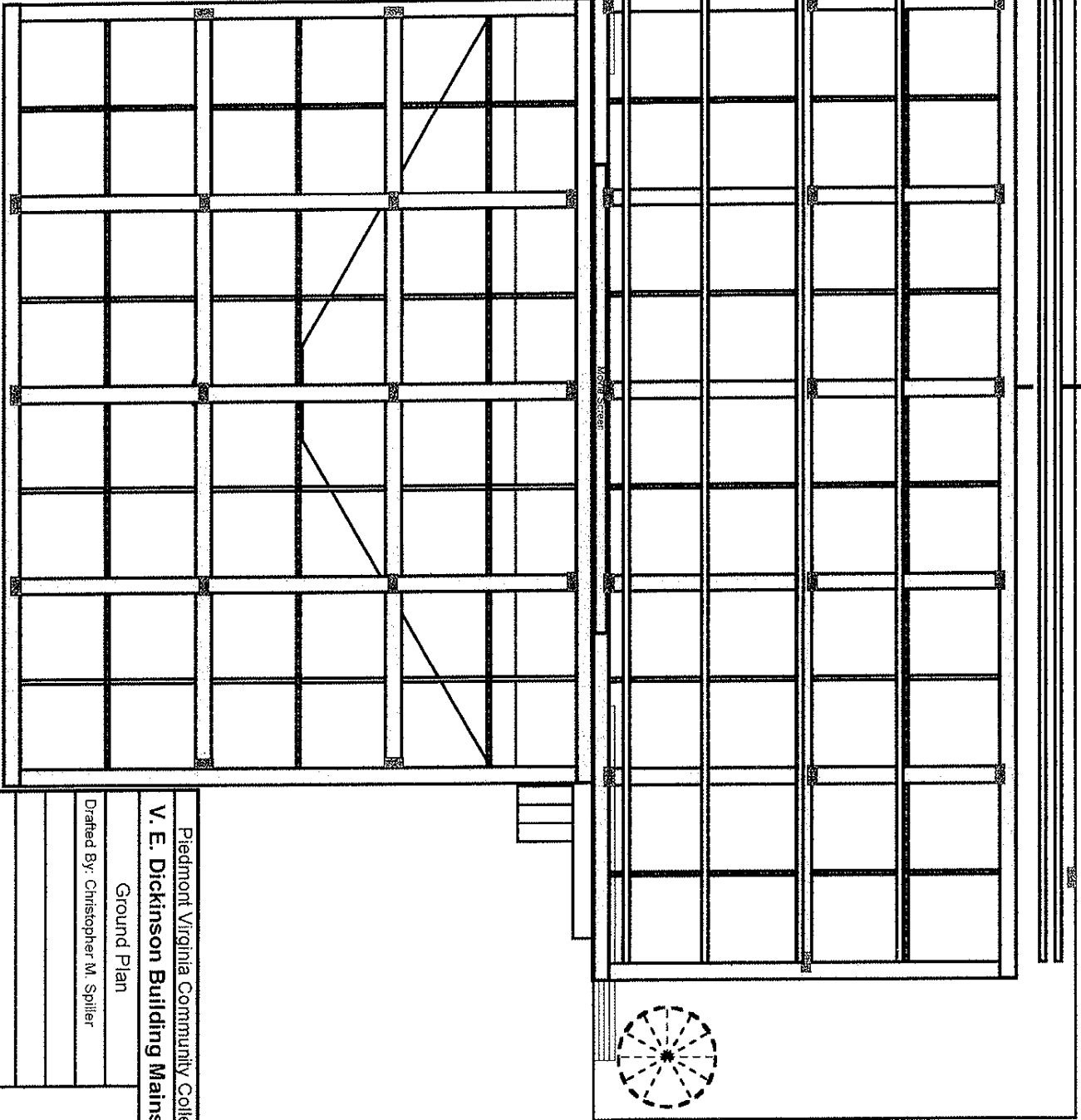

Double door to Backstage/Black Box  
 Height = 9' 11 1/2"

Piedmont Virginia Community College	
<b>V. E. Dickinson Building Mainstage</b>	
Ground Plan	Plate
Drafted By: Christopher M. Spiller	<b>1</b>
Scale: 0" = 1/4" = 1'-0" Dwg Date: 5/10/2000	Of 1

BACK WALL  
STAGE LEVEL

170-173  
BACK WALL  
STAGE LEVEL

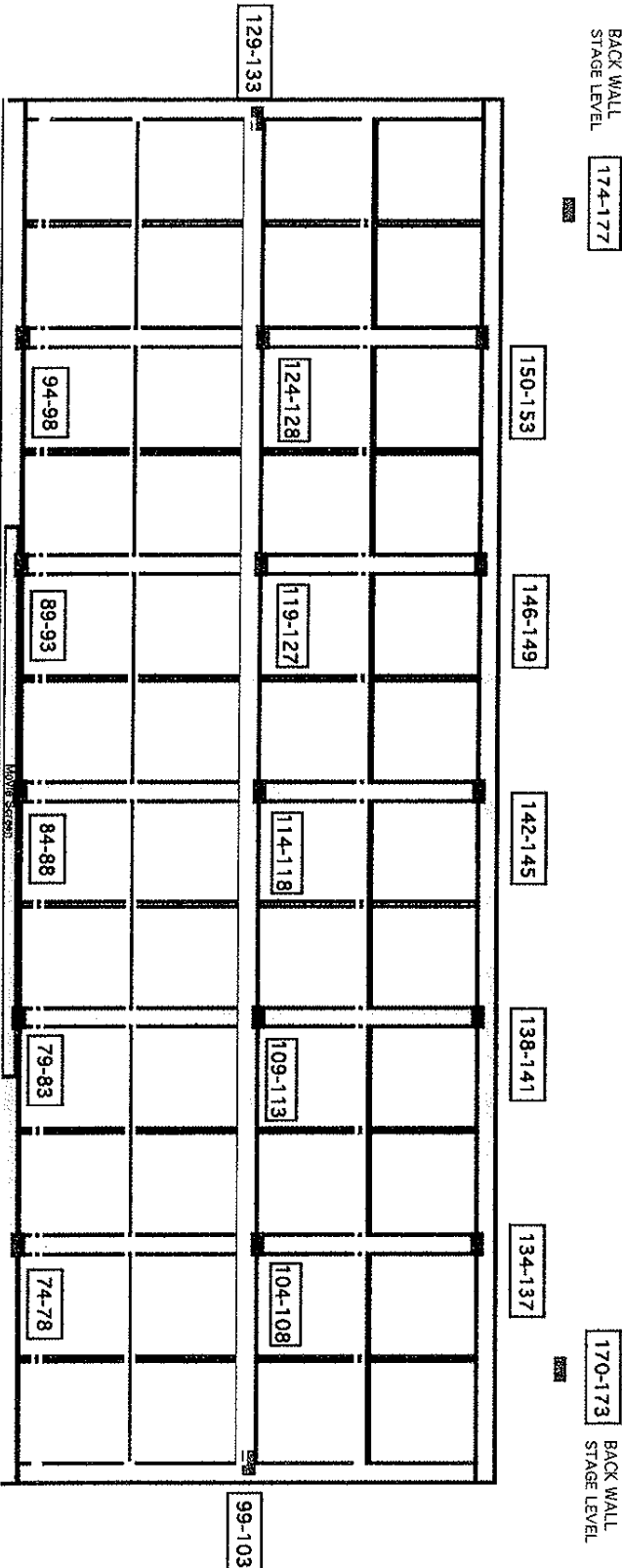

PIT DIMMERS DOWN  
STAGE RIGHT  
UNDER STAGE

178+179

166-170

HOUSE LEFT BOX BOOM  
POSITIONS

158-162

Note: Grid Bays NOT exact  
Movie screen width estimated

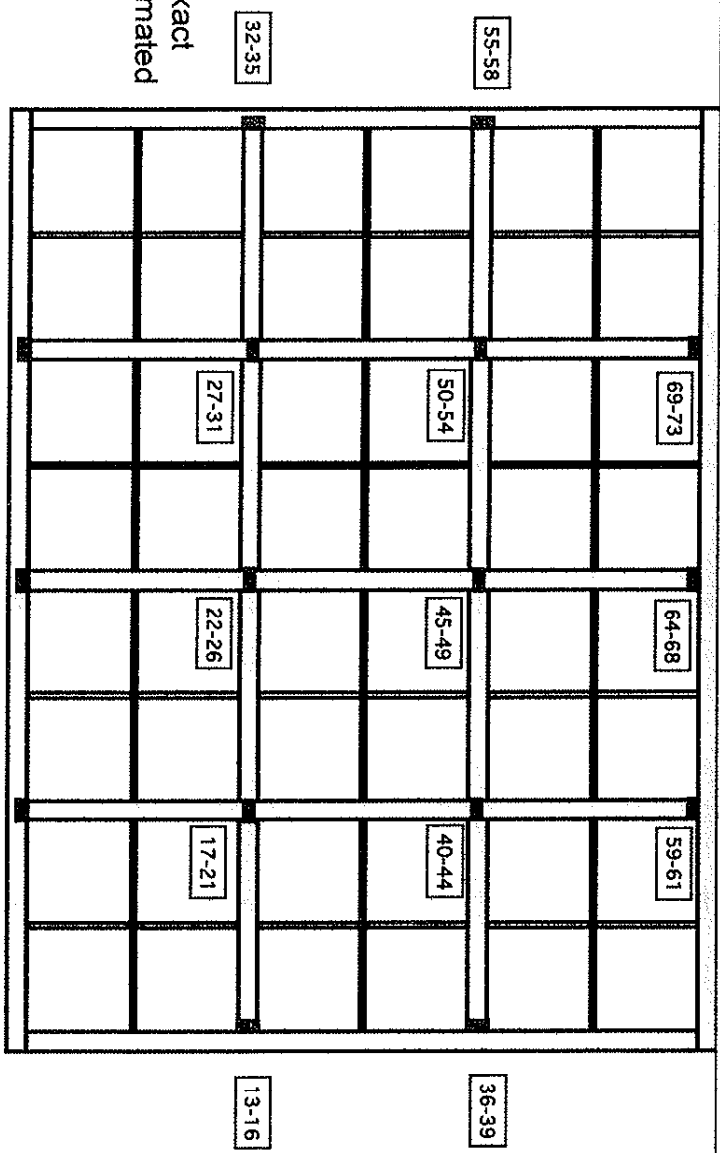

55-58

50-54

45-49

40-44

36-39

162-165

HOUSE RIGHT BOX BOOM  
POSITIONS

154-157

32-35

27-31

22-26

17-21

13-16

9-12

5-8

1-4





Plaster Line

SL Spiral staircase to grid

SR Roll door to scene shop

SL Double door to hall/black box  
Height = 9' 11 1/2"

SR Exit to hallway

19'-7 1/2"

Piedmont Virginia Community College	
V.E. Dickenson Building Maintenance	
Section at CL	
Drawn by: Christopher M. Spiller	PAU
Scale: 1/4" = 1' - 0"	Day: 14 May 2010
1 of 1	

## **PVCC Sound Inventory**

### **Mainstage Theatre**

- Studio Master Mixdown Classic 8 Sound Board located in the sound booth.
  - 24 channels
  - L – R main output faders
  - 8 sub-groups
  - 6 aux channels (3-4 post and 1-2 pre)
- One Equipment Rack in the sound booth containing:
  - Tascam 122 MKII Cassette Deck
  - Clear Com MS-232 Two-Channel Main Station
  - Audio Patch Panels
  - Rane AC 22B Active Crossover
  - EAW MX300i Signal processor
  - Pioneer DVL –919 DVD/Laser disk player
  - Panasonic AG-1339 VHS player/recorder.
- A second equipment rack in the projection booth (next to sound booth) contains:
  - Peavey MMA 875T Mixer Amp
  - 3 Peavey IP-8.5 Power Amplifiers for Main cluster.
  - 2 Peavey IP-4C Power amps for speaker monitors.
  - A Neutric speaker patch panel
  - Videotek VDA-16 Distribution Amplifier
  - Video/Audio Patch Panel
- Main Speaker Cluster – 2, KF300e 3 way full range Speakers and 1 SB330e subwoofer.
- Paging System for sending stage audio to tech booths, dressing and green rooms.
- 1 Sharp XG-P10XU LCD Projector located in the projection booth.
- Wall plates with microphone, intercom, video and monitor speaker jacks are located throughout the theatre facility. All are engraved with numbers matching the corresponding patch panels located in the Theatre projection and sound booths.

### **Maxwell Memorial Theatre (Black Box)**

- Studiomaster Trilogy 166 Soundboard
  - 12 channels
  - L – R main output faders
  - 4 sub-groups
  - 4 aux sends (3 post-fade, 1 pre-fade)
- One Equipment Rack in the sound booth containing:
  - Tascam 122 MKII Cassette Deck
  - Clear Com MS-232 Two-Channel Main Station
  - Audio Patch Panels
  - 2 Peavey IP-4C Power amps.
  - A Neutric speaker patch panel
  - Videotek VDA-16 Distribution Amplifier
  - Video/Audio Patch Panel
- Paging System for sending stage audio to tech booths, dressing and green rooms.
- Wall plates with microphone, intercom, video and monitor speaker jacks are located throughout the theatre facility. All are engraved with numbers matching the corresponding patch panels located in the Technical Theatre booth above the stage.

### **Additional Sound Equipment**

2 AKG K141 600 Ohm Headphones  
4 Bookshelf Peavy Speakers  
1 Yamaha REV 500 Digital Reverb  
1 T.C. Electronics D-TWO Multitap Delay  
1 Ashley GQX Series Model 31202 Dual Third Octive EQ  
1 Sabine Dual Channel Feedback Exterminator  
1 Presonus ACP88 Eight Channel Compressor/Limiter/Gate  
1 Allen-Heath GL2200 32x4x2 Mixer  
1 360 Systems Digi Cart II w/RC220 Remote & Mini-Keyboard  
4 Shure SLX\$ wireless UHF w/ handheld SM-58 and lavalier mics  
4 Crown PCC160 Boundry Mics  
4 Audix OM-6 Hypercardiod Dynamic Mics  
2 Shure MX418/C Microflex Gooseneck Condenser Mics  
2 Audio-Technica ATM 33a cardioid condenser mics.  
3 Audio-Technica ATM10a omni condenser mics.  
2 Audio-Technica ATM 27HE hypercardiod dynamic mics.  
5 Crown 30D PZM mics.  
3 Peavey PR-1003 weather resistant speakers  
2 Peavey ER 1500 Bass Speakers  
3 Denon DN-T 625 cassette/cd units  
2 Panasonic AG-VP320 VHS/DVD players

### **Main Stage Equipment and Lighting Inventory**

The main stage theatre has 179 available circuits.

- 73 over the house.
- 80 over the stage.
- 8 on stage.
- 4 in each of the 4 lighting ports (2 on house left and 2 house right).
- 2 in the orchestra pit.

ETC Insight 2 Lighting Board – 108 channels.

ETC Digital Address Pre-set Lighting System.

4 Source 4, 10 ° - (all Source 4's have 575w lamps)

50 Source 4, 19 °

30 Source 4, 26 °

26 Source 4, 36 °

12 Source 4, Pars

30 Colortran 6" 750w Fresnels

8 Altman 8" 1K Fresnels

10 R 40 Borderlights 300w

4 Scoops 500w

1 Lycian Midget HP Followspot